

JOB NAME \_\_\_\_\_

CONTACT \_\_\_\_\_

ORDERING CODE \_\_\_\_\_

## BINA Recessed Round Tunable White

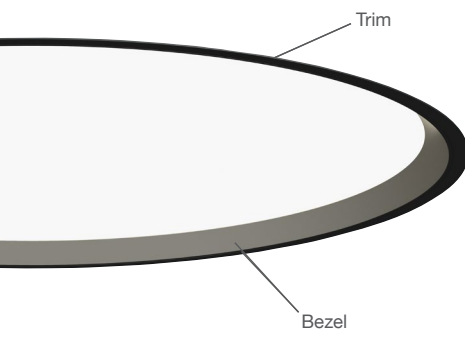

### ORDERING CODE

<b>SERIES</b>	BINA-R	bina recessed
<b>TYPE</b>	RD	round
<b>LED</b>	TW	tunable white (Luminus)
<b>CCT</b>	2765	2700K to 6500K tunable white
<b>SIZE</b>	16 24 32 40	D 16" D 24" D 32" D 40"
<b>DIRECT/INDIRECT</b>	D	direct only
<b>TRIM</b>	BK WH MC TL	black white matte chrome trimless
<b>BEZEL COLOR</b>	BK WH MC	black white matte chrome

ORDERING CODE \_\_\_\_\_

Follow the steps to specify your fixture, example:  
**BINA-R - RD - TW - 2765 - 40 - D - BK - WH**

### DESCRIPTION

Slim, 1.5" aluminum luminaire in 16", 24", 36" and 40" diameter. BINA is 0-10V or DALI dimmable to 1% using EldoLED® dual driver with static white and tunable white with a range of 2700K to 6500K.

### HOUSING

- Bezel is offered with three finishes of black, white and matte chrome.

### MOUNTING

- Offered in both trim and trimless versions with the trim version offered with three finishes of black, white and matte chrome.

### ELECTRICAL/CONTROLS

- 120-277Vac, 50/60Hz input
- 0-10V Dimming to 0.1%

### LISTING

- IP20 rating
- ETLus Listed to UL1598 (suitable for indoor use and dry locations only)
- cETL Listed to CSA C22.2 #250.0

DIRECT	4000K
16"	2880 lm
24"	3330 lm
32"	5560 lm
40"	7360 lm

### LED INFO

- Luminus MP Series LED:  
 CRI: >90, SDCM: 3-step MacAdam Ellipse, Lumen Maintenance: L<sub>70</sub> > 50,000 hrs

## PRODUCT DIMENSIONS

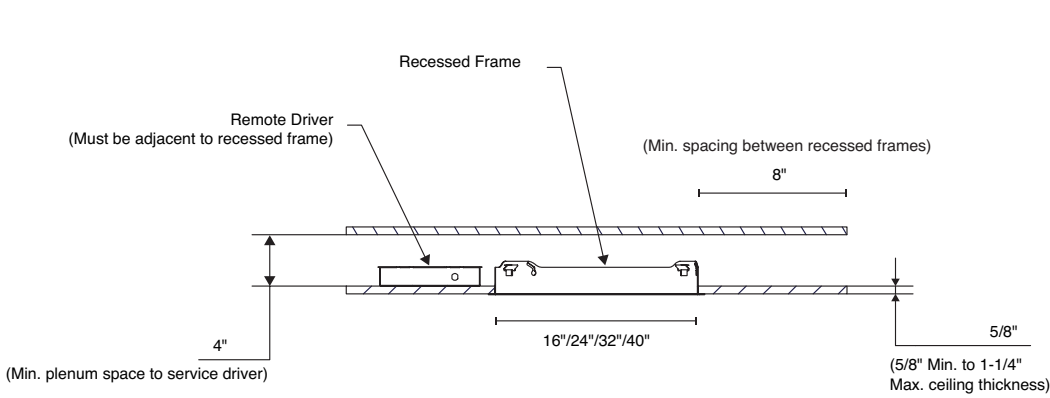
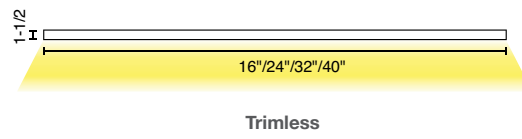
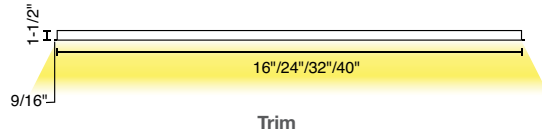

**Ceiling to Plenum - Spacing Guide**

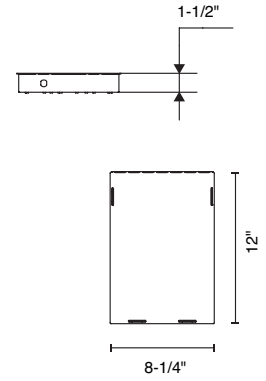

**Remote Driver Box  
(Do not mount on top of BINA body)**