

JOB NAME _____

CONTACT _____

ORDERING CODE _____

BINA Recessed Square Tunable White

ORDERING CODE

SERIES	BINA-R	bina recessed
TYPE	SQ	square
LED	TW	tunable white (Luminus)
CCT	2765	2700K to 6500K tunable white
SIZE	16 24 32 40	16"x16" 24"x24" 32"x32" 40"x40"
DIRECT/INDIRECT	D	direct only
TRIM	BK WH MC TL	black white matte chrome trimless
BEZEL COLOR	BK WH MC	black white matte chrome

ORDERING CODE _____

Follow the steps to specify your fixture, example:
BINA-R - SQ - TW - 2765 - 16 - D - TL - WH

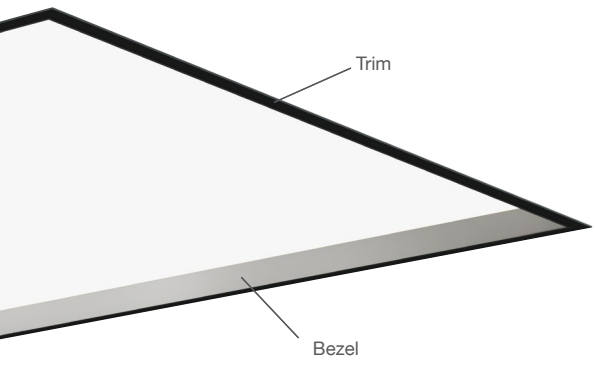
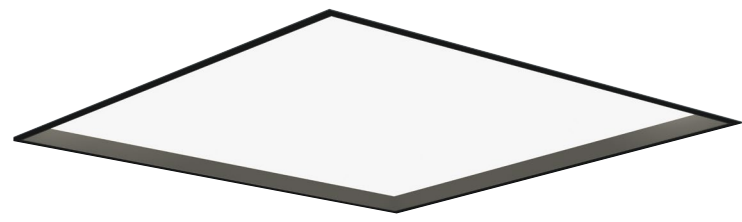

DESCRIPTION

Slim, 1.5" aluminum luminaire in 16", 24", 36" and 40" diameter. BINA is 0-10V or DALI dimmable to 1% using EldoLED® dual driver with static white and tunable white with a range of 2700K to 6500K.

HOUSING

- Bezel is offered with three finishes of black, white and matte chrome.

MOUNTING

- Offered in both trim and trimless versions with the trim version offered with three finishes of black, white and matte chrome.

ELECTRICAL/CONTROLS

- 120-277Vac, 50/60Hz input
- 0-10V Dimming to 0.1%

LISTING

- IP20 rating
- ETLus Listed to UL1598 (suitable for indoor use and dry locations only)
- cETL Listed to CSA C22.2 #250.0

DIRECT	4000K
16"	3090 lm
24"	4340 lm
32"	5670 lm
40"	8710 lm

LED INFO

- Luminus MP Series LED:
 CRI: >90, SDCM: 3-step MacAdam Ellipse, Lumen Maintenance: L₇₀ > 50,000 hrs

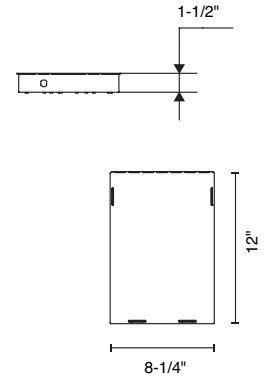
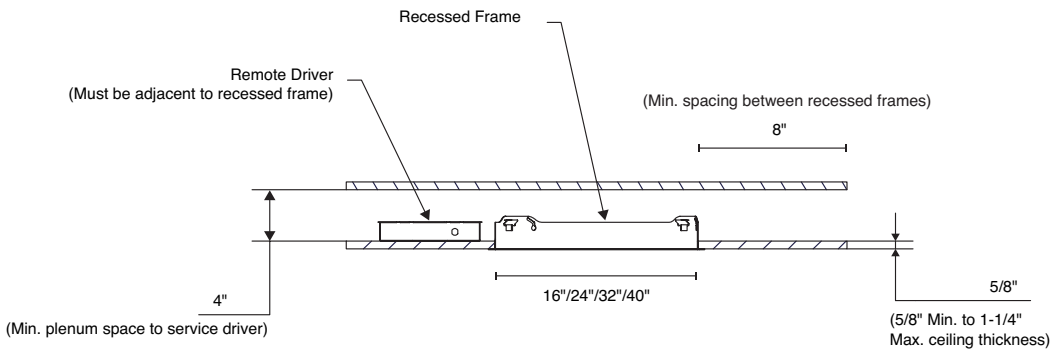
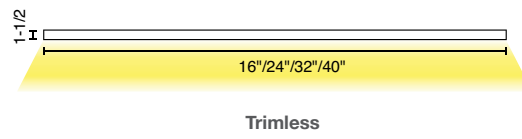
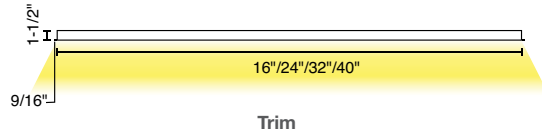

Remote Driver Box
(Do not mount on top of BINA body)