

| PROJECT INFORMATION | | |
|---------------------|--|------|
| JOB NAME | | TYPE |
| ORDERING CODE | | |

G38

Gimbal ECOJ Track Mount



ORDERING CODE

| | | |
|------------------|-------------------|-----------------|
| SERIES | G38 | PAR38 gimbal |
| TYPE | R | rear lamping |
| MOUNTING OPTIONS | ECOJ ¹ | ECOJ/JUNO track |
| VOLTAGE | 120 | 120V |
| FINISH | WH BK | white black |

ORDERING CODE

Follow the steps to specify your fixture, example:
G38 - R - 120 - ECOJ - BK

NOTES

1. Adaptor designed with adjustable conductor for 2 circuit J-Type tracks.

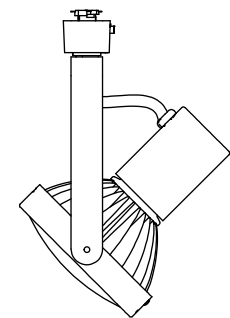
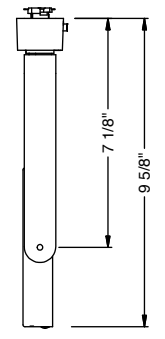
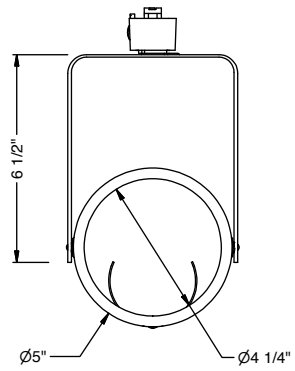
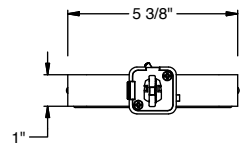

FEATURES

- PAR38 lamp, by others.
- ECOJ track - single or dual circuit
- Black or white finish

MOUNTING

- ECOJ - Juno track compatible

ELECTRICAL/CONTROLS

- 120Vac, 50-60Hz input
- Phase dimmable - PAR38 permitted
- Leading and trailing edge (Triac/ELV)
- 350; rotation, 90; tilt

LISTING

- ETLus Listed to UL1574 (track suitable for dry locations only)
- cETL Listed to CSA C22.2 #9.0