

## LX SERIES

### Cylinder Surface Mount Tunable White



BK

#### DESCRIPTION

- LX is a versatile series of performance spec-grade spots and cylinders. LX is rich in technology offering the best-in-class static and dynamic LED components, premium optics and dimming controls. Glare accessories and specialty optics are offered for all variations. Several Mounting options include nine track systems, monopoint spots and pendants, surface mount and conduit j-box cover with knockouts for open ceiling applications. It is offered in a fine detailed matte finish in black and white.

#### HOUSING

- Casted aluminum housing in textured: black and white.
- Consult factory for custom finishes.

#### MOUNTING

- Surface mount to recessed junction box.
- Surface mount to exposed junction box with JCOV mount.

#### LISTING

- CSAus Listed to 1598 (suitable for dry and damp locations)
- cCSA Listed to CSA C22.2 #9.0

#### LED INFO

- Luminus CTM (or equal) LED: SDCM = 4-step MacAdam Ellipse; Lumen Maintenance: L<sub>70</sub> > 54,000 hrs

PROJECT INFORMATION		
JOB NAME		TYPE
ORDERING CODE		

#### ORDERING CODE

SERIES	LX																								
TYPE	35																								
LED	TW	tunable white (Luminus)																							
DELIVERED LUMENS	07LM	590 lm, CBCP 3,890																							
	10LM	670 lm, CBCP 3,130																							
	15LM	900 lm, CBCP 3,250																							
	20LM	1240 lm, CBCP 4,550																							
	Calculated Delivered Lumens = [Delivered Lumen Value] x [CCT Multiplier] x [Reflector Multiplier]																								
	Standard Configuration: 3500K 30D lumens, CBCP narrow beam option																								
CCT	2765	2700K to 6500K tunable white																							
		<table border="1"> <thead> <tr> <th>CCT</th> <th>2700K</th> <th>3000K</th> <th>3500K</th> <th>4000K</th> <th>5000K</th> <th>5700K</th> <th>6500K</th> </tr> </thead> <tbody> <tr> <td>CCT MULTIPLIER FOR LUMEN OUTPUT</td> <td>0.91</td> <td>0.98</td> <td>1.00</td> <td>0.99</td> <td>1.00</td> <td>1.01</td> <td>1.02</td> </tr> <tr> <td>EMLRATIO*</td> <td>0.49</td> <td>0.57</td> <td>0.68</td> <td>0.79</td> <td>0.96</td> <td>1.04</td> <td>1.12</td> </tr> </tbody> </table>	CCT	2700K	3000K	3500K	4000K	5000K	5700K	6500K	CCT MULTIPLIER FOR LUMEN OUTPUT	0.91	0.98	1.00	0.99	1.00	1.01	1.02	EMLRATIO*	0.49	0.57	0.68	0.79	0.96	1.04
CCT	2700K	3000K	3500K	4000K	5000K	5700K	6500K																		
CCT MULTIPLIER FOR LUMEN OUTPUT	0.91	0.98	1.00	0.99	1.00	1.01	1.02																		
EMLRATIO*	0.49	0.57	0.68	0.79	0.96	1.04	1.12																		
CCT	1840	1800K to 4000K tunable white																							
		<table border="1"> <thead> <tr> <th>CCT</th> <th>1800K</th> <th>2000K</th> <th>2400K</th> <th>2700K</th> <th>3000K</th> <th>3500K</th> <th>4000K</th> </tr> </thead> <tbody> <tr> <td>CCT MULTIPLIER FOR LUMEN OUTPUT</td> <td>0.67</td> <td>0.74</td> <td>0.8</td> <td>0.85</td> <td>0.88</td> <td>0.95</td> <td>1.01</td> </tr> <tr> <td>EMLRATIO</td> <td>0.21</td> <td>0.33</td> <td>0.46</td> <td>0.53</td> <td>0.59</td> <td>0.67</td> <td>0.73</td> </tr> </tbody> </table>	CCT	1800K	2000K	2400K	2700K	3000K	3500K	4000K	CCT MULTIPLIER FOR LUMEN OUTPUT	0.67	0.74	0.8	0.85	0.88	0.95	1.01	EMLRATIO	0.21	0.33	0.46	0.53	0.59	0.67
CCT	1800K	2000K	2400K	2700K	3000K	3500K	4000K																		
CCT MULTIPLIER FOR LUMEN OUTPUT	0.67	0.74	0.8	0.85	0.88	0.95	1.01																		
EMLRATIO	0.21	0.33	0.46	0.53	0.59	0.67	0.73																		
CRI	95	95 CRI max at 3500K, 90 CRI at 6500K																							
REFLECTOR	15D <sup>1</sup>	15 degrees (1.00)																							
	20D	20 degrees (0.99)																							
	30D	30 degrees (1.00)																							
	40D	40 degrees (0.99)																							
	50D	50 degrees (0.92)																							
	LV <sup>2</sup>	LVensVector dynamic beam control 15° - 60° (0.80)																							
VOLTAGE	UNV	120V-277V																							
DIMMING	CASZ	Casambi Bluetooth dim to zero																							
	DIM10Z <sup>3</sup>	0-10V dim to zero																							
	DMXZ	DMX dim to zero																							
MOUNTING OPTIONS	S	surface mount																							
	JCOV-S	conduit junction box cover with knockouts, surface																							
FINISH	BK	black																							
	WH	white																							
ACCESSORIES	See the last page for details.																								

#### ORDERING CODE

Follow the steps to specify your fixture, example:

LX - 35 - TW - 20LM - 2765 - 95 - 20D - UNV - DIM10Z - S - WH

TW (LED)	POWER
DELIVERED LM	W (95 CRI)
590	15
670	13
900	19
1240	27

#### NOTES

1. 15D only available in 07LM.
2. LV available only in 07LM with CASZ or DMXZ. Length of fixture increases by 1/8".
3. Requires 2 wall controllers (see wiring diagram).
4. EML = equivalent melanopic lux. To calculate EML, multiply the measured photopic lux by the EML ratio for the given CCT. Example: 254 lux x 0.79 = 200 melanopic lux at 4000K.

## PROJECT INFORMATION

JOB NAME		TYPE	
ORDERING CODE			

## MOUNTING OPTIONS

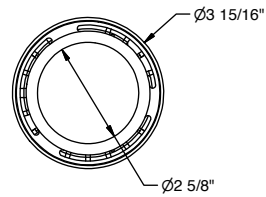
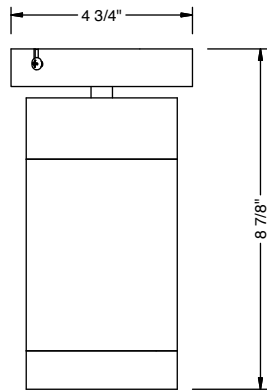

### SURFACE MOUNT

**PROJECT INFORMATION**

JOB NAME		TYPE	
ORDERING CODE			

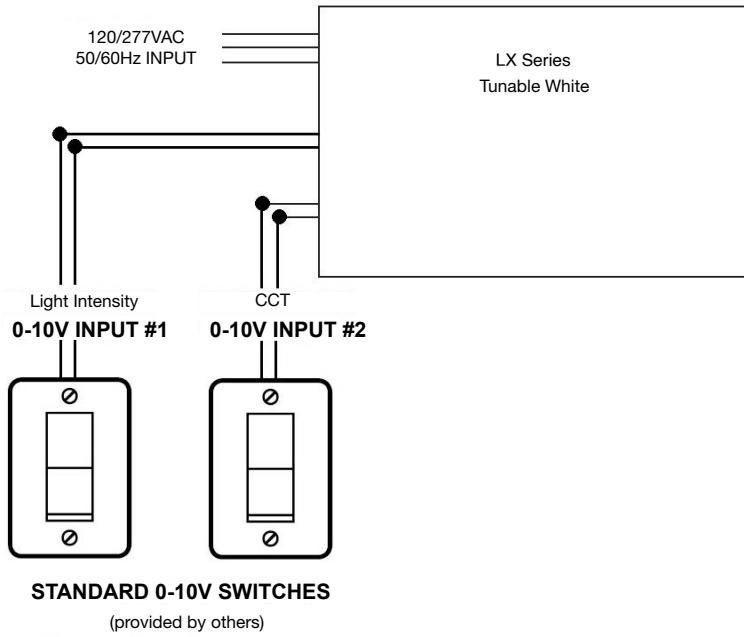
**WIRING DIAGRAMS****"DIM10" HARDWIRED 0-10V CONTROL**

**PROJECT INFORMATION**

JOB NAME		TYPE	
ORDERING CODE			

**ACCESSORIES**

**Accessories Ordering Codes<sup>1,2,3</sup>**

<b>HCL</b>	honeycomb louver (Cat. No. 81331)
<b>BDBK</b>	barndoor, black (Cat. No. K20278)
<b>SNTBK</b>	snoot, black (Cat. No. 81347BK)
<b>SNTWH</b>	snoot, white (Cat. No. 81347WH)
<b>SHNTBK</b>	shroud snoot, black (Cat. No. 81348BK)
<b>SHNTWH</b>	shroud snoot, white (Cat. No. 81348WH)
<b>E</b>	elliptical lens, 30° X 60° (Cat. No 74258)
<b>SBL</b>	smoothing beam lens (Cat. No 74207-SBL)
<b>DL</b>	diffused lens (Cat. No 74207)

<b>BW</b>	batwing lens (Cat. No 74259)
<b>AB</b>	asymmetric beam lens (Cat. No 74261)
<b>HET</b>	high efficiency textured lens, similar to Solite™ (Cat. No. 74262)
<b>GRL</b>	glare reduction lens (Cat. No. 74257)
<b>CF-RD</b>	color filter - red (Cat. No 74272-RD)
<b>CF-BL</b>	color filter - blue (Cat. No 74272-BL)
<b>CF-GR</b>	color filter - green (Cat. No 74272-GR)
<b>CF-AM</b>	color filter - amber (Cat. No 74272-AM)
<b>81464</b>	bezel removal tool

**NOTES**

1. Complete fixture ordering code by adding accessory ordering code. To order the accessory only use the catalog number.
2. Maximum 2pcs of media per fixture. Standard Configuration includes clear lens, which is replaceable with other media.
3. For best performance pair lenses with 15D or 20D beam options.

**LIGHT DISTRIBUTION**

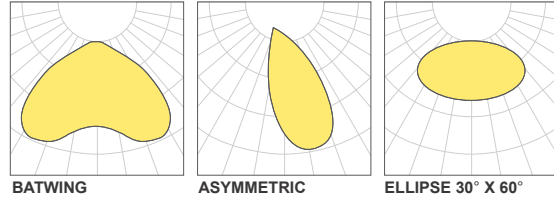

**HONEYCOMB LOUVER**



**SNOOT**

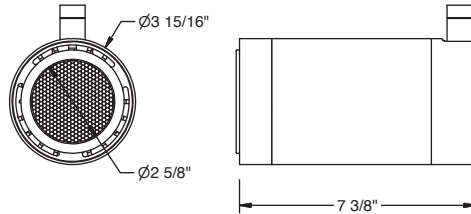

**SHROUD SNOOT**

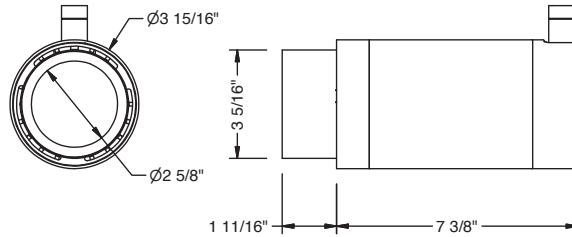

**BARNDOOR**

