

LX SERIES

Spot Monopoint RGBW



BK

DESCRIPTION

- LX is a versatile series of performance spec-grade spots and cylinders. LX is rich in technology offering the best-in-class static and dynamic LED components, premium optics and dimming controls. Glare accessories and specialty optics are offered for all variations. Several Mounting options include nine track systems, monopoint spots and pendants, surface mount and conduit j-box cover with knockouts for open ceiling applications. It is offered in a fine detailed matte finish in black and white.

HOUSING

- Casted aluminum housing in textured: black and white.
- Consult factory for custom finishes.

MOUNTING

- Monopoint with field cuttable stem.
- Monopoint to exposed junction box with JCOV mount, field cuttable stem.

LISTING

- CSAus Listed to 1598 (suitable for dry and damp locations)
- cCSA Listed to CSA C22.2 #9.0

LED INFO

- LED ENGIN LuxiGen LED: SDCM = 3-step MacAdam Ellipse; Lumen Maintenance: L₇₀ > 20,000 hrs per emitter

PROJECT INFORMATION

JOB NAME		TYPE	
ORDERING CODE			

ORDERING CODE

SERIES	LX		
TYPE	35		
LED	RGBW	red, green, blue, white (white at 4000K)	
DELIVERED LUMENS	10LM ¹ 15LM ^{1,2} 20LM ^{1,2}	500 lm, CBCP 2.960 675 lm, CBCP 4.410 750 lm, CBCP 5.040 <small>Standard Configuration: White at 4000K 15D lumens, CBCP narrow beam option</small>	
CRI	90	90 CRI	
REFLECTOR	15D 25D 40D 60D LV ³	15 degrees (1.00) 25 degrees (1.00) 40 degrees (0.99) 60 degrees (0.92) LensVector dynamic beam control 15° - 60° (0.80)	
VOLTAGE	UNV	120V-277V	
DIMMING	CASZ DMXZ	Casambi Bluetooth dim to zero DMX dim to zero	
MOUNTING OPTIONS	MP JCOV-MP	monopoint canopy 24" field cuttable to 1" conduit junction box cover with knockouts, monopoint 24" field cuttable to 1"	
FINISH	BK WH	black white	
ACCESSORIES	See the last page for details.		

ORDERING CODE

Follow the steps to specify your fixture, example:

LX - 35 - RGBW - 20LM - 90 - 40D - UNV - CASZ - MP - WH

RGBW (LED)					POWER
DELIVERED LM					W (90 CRI)
ALL	RED	GREEN	BLUE	WHITE	-
1000	240	340	120	500	22
1300	320	430	140	675	35
1500	350	480	160	750	44

Power Factor ≥ 0.9

NOTES

- Reference power table for "ALL ON" and individual color outputs.
- 20LM and 15LM available only with additional 1" extended canopy.
- LV available only in Casambi and DMX. Standard Configuration: Narrowest beam. Length of fixture increases by 1/8".

PROJECT INFORMATION

JOB NAME		TYPE	
ORDERING CODE			

MOUNTING OPTIONS

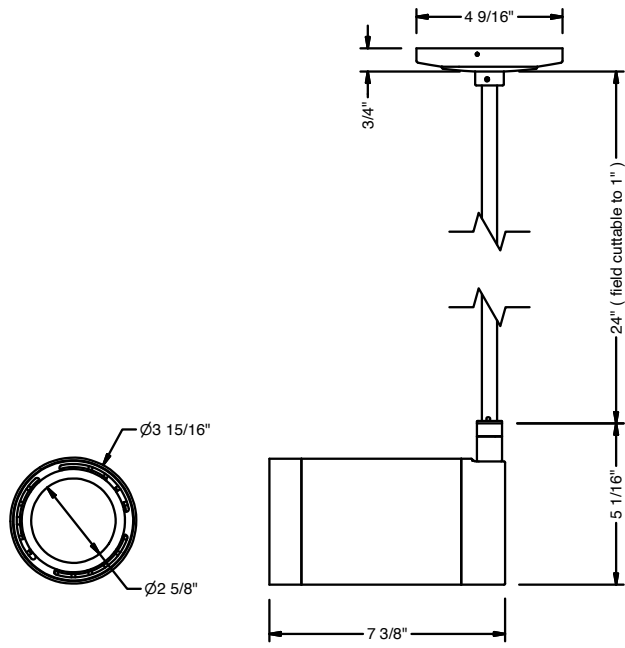

MONOPOINT

PROJECT INFORMATION

JOB NAME		TYPE	
ORDERING CODE			

ACCESSORIES

Accessories Ordering Codes^{1,2,3}

HCL	honeycomb louver (Cat. No. 81331)
BDBK	barndoor, black (Cat. No. K20278)
SNTBK	snoot, black (Cat. No. 81347BK)
SNTWH	snoot, white (Cat. No. 81347WH)
SHNTBK	shroud snoot, black (Cat. No. 81348BK)
SHNTWH	shroud snoot, white (Cat. No. 81348WH)
E	elliptical lens, 30° X 60° (Cat. No 74258)
SBL	smoothing beam lens (Cat. No 74207-SBL)
DL	diffused lens (Cat. No 74207)

BW	batwing lens (Cat. No 74259)
AB	asymmetric beam lens (Cat. No 74261)
HET	high efficiency textured lens, similar to Solite™ (Cat. No. 74262)
GRL	glare reduction lens (Cat. No. 74257)
CF-RD	color filter - red (Cat. No 74272-RD)
CF-BL	color filter - blue (Cat. No 74272-BL)
CF-GR	color filter - green (Cat. No 74272-GR)
CF-AM	color filter - amber (Cat. No 74272-AM)
81464	bezel removal tool

NOTES

1. Complete fixture ordering code by adding accessory ordering code. To order the accessory only use the catalog number.
2. Maximum 2pcs of media per fixture. Standard Configuration includes clear lens, which is replaceable with other media.
3. For best performance pair lenses with 15D or 25D beam option.

LIGHT DISTRIBUTION

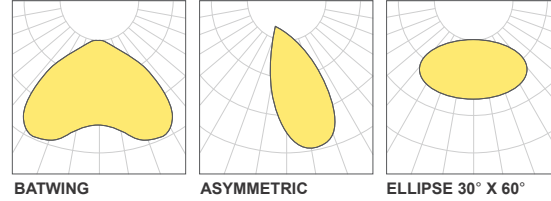

HONEYCOMB LOUVER

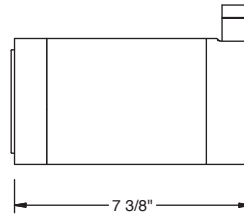
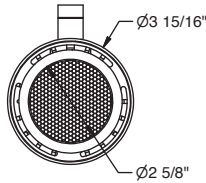

SNOOT

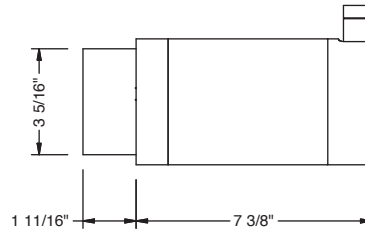
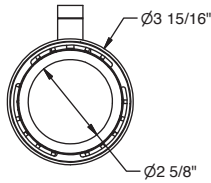

SHROUD SNOOT

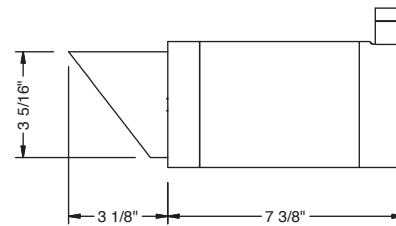
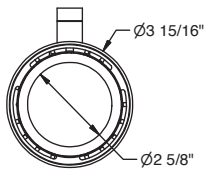

BARNDOOR

