

LX SERIES

Track Spot Tunable White



BK

DESCRIPTION

- LX is a versatile series of performance spec-grade spots and cylinders. LX is rich in technology offering the best-in-class static and dynamic LED components, premium optics and dimming controls. Glare accessories and specialty optics are offered for all variations. Several Mounting options include nine track systems, monopoint spots and pendants, surface mount and conduit j-box cover with knockouts for open ceiling applications. It is offered in a fine detailed matte finish in black and white.

HOUSING

- Casted aluminum housing in textured: black and white.
- Consult factory for custom finishes.

MOUNTING

- Global track systems, GEO track, ECO track / HALO® Power Trac track, Zonyx track, Juno® track, and Lightolier®.

LISTING

- CSAus Listed to UL1574 (track suitable for dry locations only).
- cCSA Listed to CSA C22.2 #9.0

LED INFO

- Luminus CTM (or equal) LED: SDCM = 4-step MacAdam Ellipse; Lumen Maintenance: L₇₀ > 54,000 hrs

PROJECT INFORMATION			
JOB NAME		TYPE	
ORDERING CODE			

ORDERING CODE

SERIES	LX																																																						
TYPE	35																																																						
LED	TW tunable white (Luminus)																																																						
DELIVERED LUMENS	07LM 590 lm, CBCP 3,890 10LM 670 lm, CBCP 3,130 15LM 900 lm, CBCP 3,250 20LM 1240 lm, CBCP 4,550 Calculated Delivered Lumens = [Delivered Lumen Value] x [CCT Multiplier] x [Reflector Multiplier] Standard Configuration: 3000K 30D lumens, CBCP narrow beam option																																																						
CCT	2765 2700K to 6500K tunable white <table border="1"> <thead> <tr> <th>CCT</th> <th>2700K</th> <th>3000K</th> <th>3500K</th> <th>4000K</th> <th>5000K</th> <th>5700K</th> <th>6500K</th> </tr> </thead> <tbody> <tr> <td>CCT MULTIPLIER FOR LUMEN OUTPUT</td> <td>0.91</td> <td>0.98</td> <td>1.00</td> <td>0.99</td> <td>1.00</td> <td>1.01</td> <td>1.02</td> </tr> <tr> <td>EML RATIO¹</td> <td>0.49</td> <td>0.57</td> <td>0.68</td> <td>0.79</td> <td>0.96</td> <td>1.04</td> <td>1.12</td> </tr> </tbody> </table> 1840 1800K to 4000K tunable white <table border="1"> <thead> <tr> <th>CCT</th> <th>1800K</th> <th>2000K</th> <th>2400K</th> <th>2700K</th> <th>3000K</th> <th>3500K</th> <th>4000K</th> </tr> </thead> <tbody> <tr> <td>CCT MULTIPLIER FOR LUMEN OUTPUT</td> <td>0.67</td> <td>0.74</td> <td>0.8</td> <td>0.85</td> <td>0.88</td> <td>0.95</td> <td>1.01</td> </tr> <tr> <td>EML RATIO</td> <td>0.21</td> <td>0.33</td> <td>0.46</td> <td>0.53</td> <td>0.59</td> <td>0.67</td> <td>0.73</td> </tr> </tbody> </table>							CCT	2700K	3000K	3500K	4000K	5000K	5700K	6500K	CCT MULTIPLIER FOR LUMEN OUTPUT	0.91	0.98	1.00	0.99	1.00	1.01	1.02	EML RATIO ¹	0.49	0.57	0.68	0.79	0.96	1.04	1.12	CCT	1800K	2000K	2400K	2700K	3000K	3500K	4000K	CCT MULTIPLIER FOR LUMEN OUTPUT	0.67	0.74	0.8	0.85	0.88	0.95	1.01	EML RATIO	0.21	0.33	0.46	0.53	0.59	0.67	0.73
CCT	2700K	3000K	3500K	4000K	5000K	5700K	6500K																																																
CCT MULTIPLIER FOR LUMEN OUTPUT	0.91	0.98	1.00	0.99	1.00	1.01	1.02																																																
EML RATIO ¹	0.49	0.57	0.68	0.79	0.96	1.04	1.12																																																
CCT	1800K	2000K	2400K	2700K	3000K	3500K	4000K																																																
CCT MULTIPLIER FOR LUMEN OUTPUT	0.67	0.74	0.8	0.85	0.88	0.95	1.01																																																
EML RATIO	0.21	0.33	0.46	0.53	0.59	0.67	0.73																																																
CRI	95 95 CRI max at 3500K, 90 CRI at 6500K																																																						
REFLECTOR & LM MULTIPLIER	15D¹ 15 degrees (1.00) 20D 20 degrees (0.99) 30D 30 degrees (1.00) 40D 40 degrees (0.99) 50D 50 degrees (0.92) LV² LensVector dynamic beam control 15°- 60° (0.80)																																																						
VOLTAGE	120 120V																																																						
DIMMING	CASZ Casambi Bluetooth dim to zero																																																						
MOUNTING OPTIONS	ECO ECO/HALO - single circuit JUNO Juno - single circuit LGTR Lightolier spot - single circuit GEO GEO spot - two circuit, two neutral ZON³ Zonyx spot - single circuit																																																						
FINISH	BK black WH white																																																						
ACCESSORIES	See the last page for details.																																																						

ORDERING CODE

Follow the steps to specify your fixture, example:

LX - 35 - TW - 20LM - 2765 - 95 - 20D - 120 - CASZ - ECO - WH

TW (LED)	POWER
DELIVERED LM	W (95 CRI)
590	15
670	13
900	19
1240	27

NOTES

- 15D only available in 07LM.
- LV only available in 07LM. Length of fixture increases by 1/8".
- Zonyx track adapter available only in MC.
- EML = equivalent melanopic lux. To calculate EML, multiply the measured photopic lux by the EML ratio for the given CCT.
Example: 254 lux x 0.79 = 200 melanopic lux at 4000K.

JOB NAME		TYPE	
ORDERING CODE			

MOUNTING OPTIONS

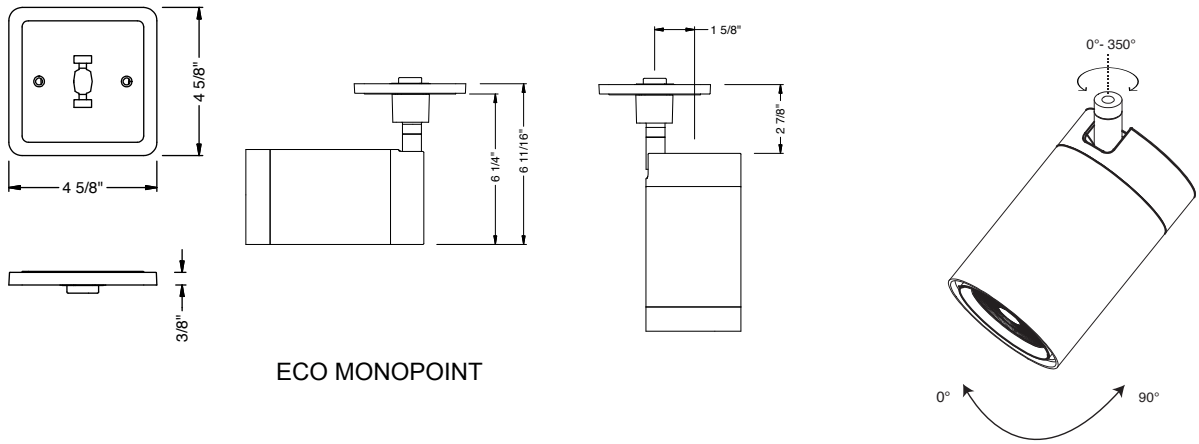
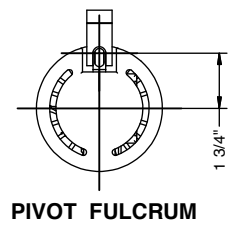
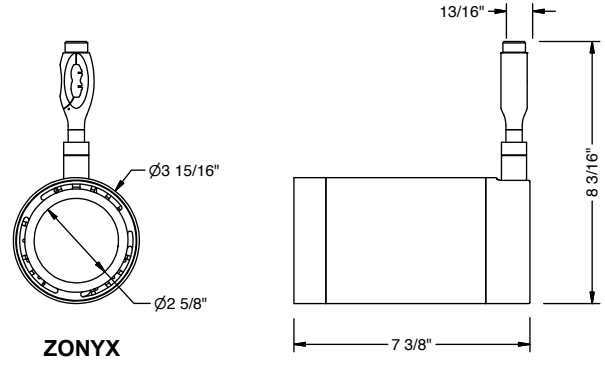
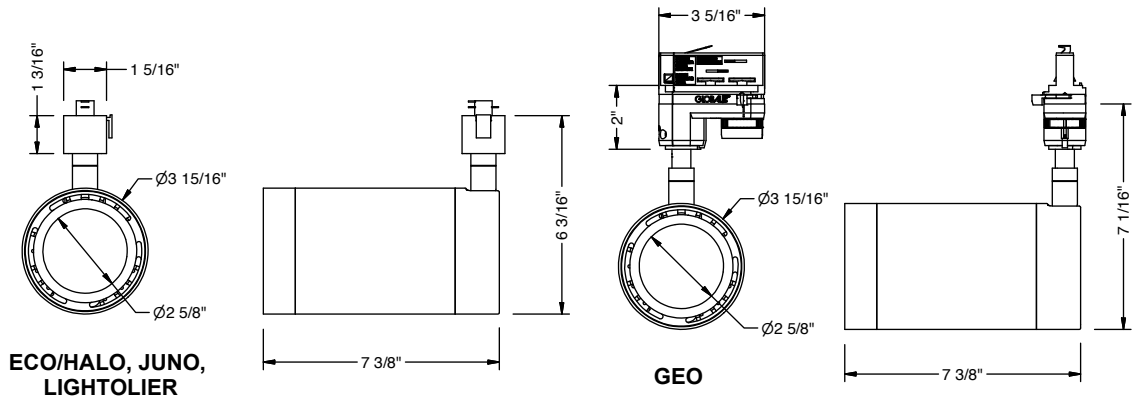

PROJECT INFORMATION			
JOB NAME		TYPE	
ORDERING CODE			

ACCESSORIES

Accessories Ordering Codes^{1,2,3}

HCL	honeycomb louver (Cat. No. 81331)
BDBK	barndoor, black (Cat. No. K20278)
SNTBK	snoot, black (Cat. No. 81347BK)
SNTWH	snoot, white (Cat. No. 81347WH)
SHNTBK	shroud snoot, black (Cat. No. 81348BK)
SHNTWH	shroud snoot, white (Cat. No. 81348WH)
E	elliptical lens, 30° X 60° (Cat. No. 74258)
SBL	smoothing Beam lens (Cat. No. 74207-SBL)
DL	diffused lens (Cat. No. 74207)
BW	batwing lens (Cat. No. 74259)

AB	asymmetric beam lens (Cat. No. 74261)
HET	high efficiency textured lens, similar to Solite™ (Cat. No. 74262)
GRL	glare reduction lens (Cat. No. 74257)
CF-RD	color filter - red (Cat. No. 74272-RD)
CF-BL	color filter - blue (Cat. No. 74272-BL)
CF-GR	color filter - green (Cat. No. 74272-GR)
CF-AM	color filter - amber (Cat. No. 74272-AM)
81464	bezel removal tool
K20272/ECOMPBK	ECO canopy square, black
K20272/ECOMPWH	ECO canopy square, white

NOTES

- Complete fixture ordering code by adding accessory ordering code. To order the accessory only use the catalog number.
- Maximum 2pcs of media per fixture. Standard Configuration includes clear lens, which is replaceable with other media.
- For best performance pair lenses with 15D or 20D beam options.

LIGHT DISTRIBUTION

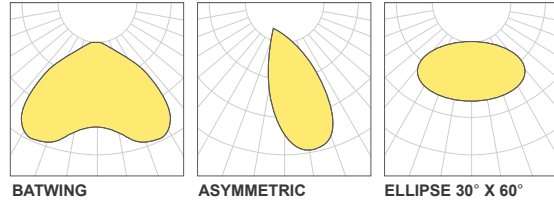

HONEYCOMB LOUVER



SNOOT

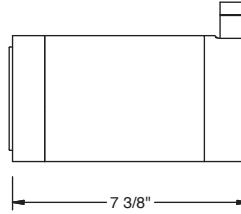
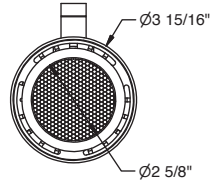

SHROUD SNOOT

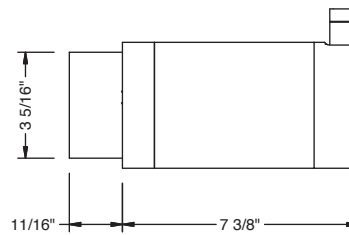
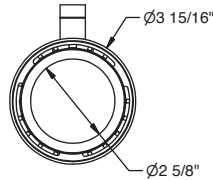

BARNDOOR

