

PROJECT INFORMATION		
JOB NAME		TYPE
ORDERING CODE		

## MSX25

### MEVO Stucchi Track Standard White



20° - 55° BEAM		
(Note: Specifications are subject to change without notice)		
14mm COB PERFORMANCE DATA		
LED LIGHT ENGINE	NOMINAL DELIVERED LUMENS	SYSTEM WATTAGE
10LM	850LM @30K/90CRI	13W
15LM	1150LM @30K/90CRI	17W
20LM	1670LM @30K/90CRI	23W
25LM	2385LM @30K/90CRI	30W
Notes	Delivered lumens based on 55D	

#### FEATURES

- Seamless casting with textured finish for clean aesthetics
- Flush stem regression at 0°
- 20° - 55° beam spread
- UGR < 19
- Mounting options include various STUCCHI track systems

#### DIMMING AND CONTROLS

- Flicker free 0-10V dimming to 0%

#### CONSTRUCTION

- Casted aluminum housing
- PMMA optics

#### LED

- Citizen (or equal) LED: SDCM: 2-step MacAdam Ellipse, Lumen Maintenance: L<sub>70</sub> > 66,000 hrs

#### LISTING

- CSAus Listed to UL1574; cCSA Listed to CSA C22.2 #9.0
- Suitable for dry and damp locations
- 5 Year Limited warranty

#### ELECTRICAL

- 48V (Casambi, 0-10V)
- Power factory ≥ 0.9
- 2kV driver input surge protection

#### SPOT

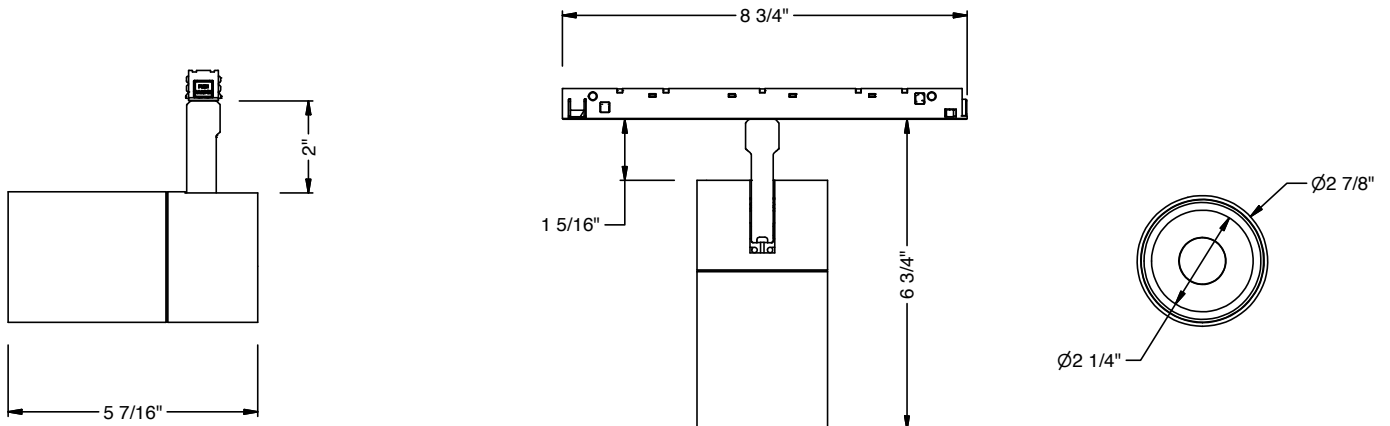

# bruck

PROJECT INFORMATION		
JOB NAME		TYPE
ORDERING CODE		

ORDERING CODE		
<b>SERIES</b>	<b>MSX25</b>	msx
<b>LED</b>	<b>SW</b>	standard white
<b>DELIVERED LUMENS</b>	<b>10LM</b>	850lm
	<b>15LM</b>	1150lm
	<b>20LM</b>	1670lm
	<b>25LM</b>	2385lm
Standard Configuration: 3000K 55D Calculated Delivered Lumens = [Delivered Lumen Value] x [CCT Multiplier] x [Optic Multiplier] x [Lens Multiplier]		
<b>CCT</b>	<b>27K</b>	2700K (0.97)
	<b>30K</b>	3000K (1.00)
	<b>35K</b>	3500K (1.02)
<b>CRI</b>	<b>90</b>	90 CRI
<b>OPTIC &amp; LM MULTIPLIER</b>	<b>20D</b>	20 degrees (0.91)
	<b>35D</b>	35 degrees (0.98)
	<b>55D</b>	55 degrees (1.00)
<b>BEZEL LENS</b>	<b>HCL</b>	honeycomb louver (0.70)
<b>FINISH</b>	<b>BK</b>	black
	<b>WH</b>	white

ORDERING CODE		
<b>MOUNTING OPTIONS</b>	<b>MEVO</b>	48V stucchi multisystem track spot
<b>VOLTAGE</b>	<b>48</b>	48V
<b>DIMMING</b>	<b>DIM10Z</b>	0-10V dim to zero

YOUR COMPLETED ORDERING CODE	
Follow the steps to specify your fixture, example:	
<b>MSX25 - SW - 10LM - 30K - 90 - 35D - HCL - BK - MEVO - 48 - DIM10Z</b>	

PROJECT INFORMATION		
JOB NAME		TYPE
ORDERING CODE		

## MOUNTING OPTIONS

