

PROJECT INFORMATION			
JOB NAME		TYPE	
ORDERING CODE			

## SERA 6

### 6" Square Down IP65 Wall

25° - 55° BEAM		
(Note: Specifications are subject to change without notice)		
14mm COB PERFORMANCE DATA		
LED LIGHT ENGINE	NOMINAL DELIVERED LUMENS	SYSTEM WATTAGE
30LM	2700LM @30K/90CRI	27W
Notes	Delivered lumens based on 25D optic.(see page 2)	



#### FEATURES

- Pre finish anodizing process for corrosive-inhibiting protection
- 2 Finish options: Anthracite or Silver
- 3000K or 4000K CCT options
- 25° - 55° Optical beam control
- Louver (Slit) accessory
- IP65 Rated

#### DIMMING AND CONTROLS

- 0-10V dimming

#### CONSTRUCTION

- Extruded aluminum housing
- Anodized and powder coat finish
- Mount to 3-1/2" to 4" octagonal or 4" square recessed junction box

#### LED

- LED: Zigen ZG6CGD34Z0S
- SDCM: 3-step MacAdam Ellipse
- Lumen Maintenance:  $L_{70} > 50,000$  hrs

#### LISTING

- ETLus Listed to UL1598 (suitable for wet locations)
- cETL Listed to CSA C22.2 #250.0
- Warranty: 5 year limited warranty
- BUG Rating: B1 - U1 - G
- 3000k or warmer must be selected for International Dark-Sky Association approval

#### ELECTRICAL

- 120V-277V
- Ambient operating temperature -20°C/-4°F to +40°C/+104°F

#### WALL

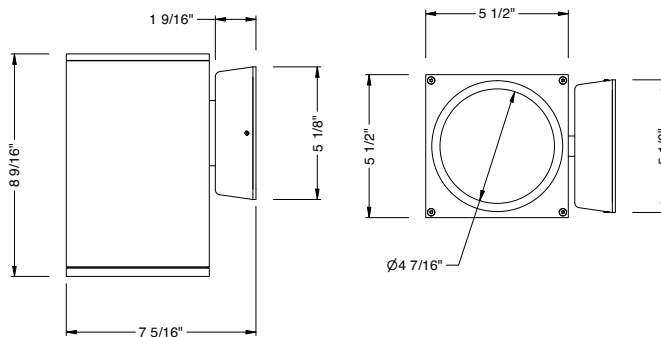

PROJECT INFORMATION		
JOB NAME		TYPE
ORDERING CODE		

BEAM ORDERING CODE			
SERIES	EXT	exterior	
TYPE	6QD	6" square wall down, 27W	
LED	SW	standard white	
DELIVERED LUMENS	30LM	2700 lm	
	Standard Configuration: 3000K Calculated Delivered Lumens = [Delivered Lumen Value] x [CCT Multiplier] x [Optic Multiplier]		
CCT	30K	3000K	
	40K	4000K	
CRI	90	90 CRI	
OPTIC & LM MULTIPLIER SEE PAGE 3	25D	25° reflector	(1.00)
	35D	35° reflector	(0.94)
	55D	55° reflector	(0.98)
	SLT <sup>1</sup>	70° X 10° louver	(0.05)
FINISH	BK	anthracite	
	SV	silver	

BEAM ORDERING CODE		
MOUNTING OPTIONS	W <sup>2</sup>	wall mount
VOLTAGE	UNV-10V	120V-277V integrated driver, flicker free 0-10V dimming to 10%

YOUR COMPLETED ORDERING CODE	
Follow the steps to specify your fixture, example:	
<b>EXT - 6QD - SW - 30LM - 30K - 90 - 35D - BK - W - UNV - 10V</b>	

**NOTES**

1. Slit louver for light affect, not available with 25D/35D/55D.
2. Up or down wall mounting. Not BUG or Dark Sky rated in up mount.

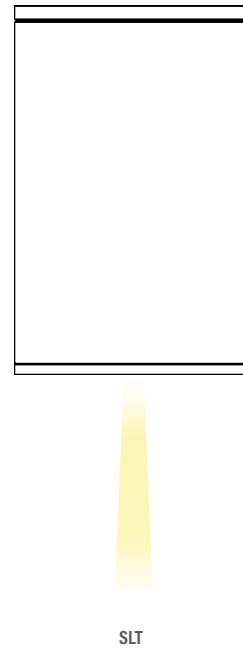
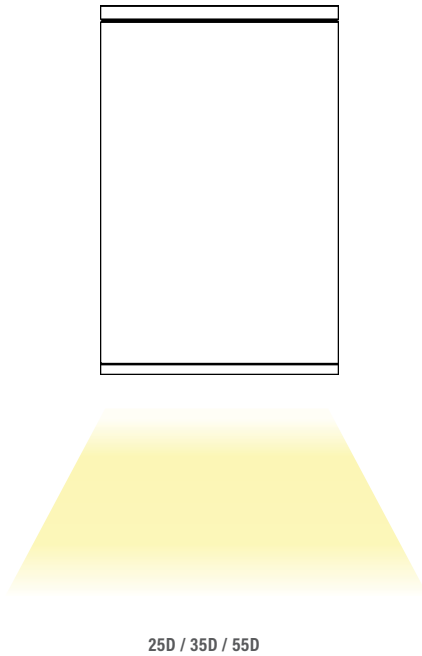

**PROJECT INFORMATION**

JOB NAME		TYPE	
ORDERING CODE			

**PHOTOMETRIC DATA**

**30LM CCT MULTIPLIERS**

	<b>90CRI</b>
<b>3000K</b>	<b>1</b>
<b>4000K</b>	<b>1.1</b>
<b>FC Formula = CBCP / Distance<sup>2</sup></b>	

25D 25°	
	<p>Throw Distance (ft)</p> <p>Beam Diameter (ft)</p> <p>Illuminance at Center (fc)</p>
WATTS:: 26.7	LPW:: 102.4
LUMENS: 2734	CCT:: 3000K
INTENSITY	
DEGREE	CANDELA
0	8747
5	7537
15	3598
25	1392
35	702
45	28

35D 37°	
	<p>Throw Distance (ft)</p> <p>Beam Diameter (ft)</p> <p>Illuminance at Center (fc)</p>
WATTS:: 26.7	LPW:: 96.5
LUMENS: 2577	CCT:: 3000K
INTENSITY	
DEGREE	CANDELA
0	5339
5	5214
15	3588
25	1383
35	712
45	32

55D 57°	
	<p>Throw Distance (ft)</p> <p>Beam Diameter (ft)</p> <p>Illuminance at Center (fc)</p>
WATTS:: 26.7	LPW:: 100.3
LUMENS: 2677	CCT:: 3000K
INTENSITY	
DEGREE	CANDELA
0	3328
5	3284
15	2914
25	1939
35	1003
45	55