

PROJECT INFORMATION		
JOB NAME		TYPE
ORDERING CODE		

## SERA 6

6" Round Down IP65 Surface

25° - 55° BEAM		
(Note: Specifications are subject to change without notice)		
14mm COB PERFORMANCE DATA		
LED LIGHT ENGINE	NOMINAL DELIVERED LUMENS	SYSTEM WATTAGE
30LM	2700LM @30K/90CRI	27W
Notes	Delivered lumens based on 25D optic.(see page 2)	



### FEATURES

- Pre finish anodizing process for corrosive-inhibiting protection
- 2 Finish options: Anthracite or Silver
- 3000K or 4000K CCT options
- 25° - 55° Optical beam control
- Louver (Slit) accessory
- IP65 Rated

### DIMMING AND CONTROLS

- 0-10V dimming

### CONSTRUCTION

- Extruded aluminum housing
- Anodized and powder coat finish
- Mount to 3-1/2" to 4" octagonal or 4" square recessed junction box

### LED

- LED: Zigen ZG6CGD34Z0S
- SDCM: 3-step MacAdam Ellipse
- Lumen Maintenance:  $L_{70} > 50,000$  hrs

### LISTING

- ETLus Listed to UL1598 (suitable for wet locations)
- cETL Listed to CSA C22.2 #250.0
- Warranty: 5 year limited warranty
- BUG Rating: B1 - U1 - G
- 3000k or warmer must be selected for International Dark-Sky Association approval

### ELECTRICAL

- 120V-277V
- Ambient operating temperature -20°C/-4°F to +40°C/+104°F

### SURFACE

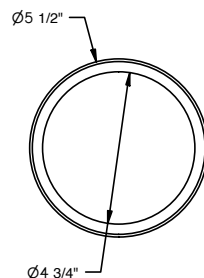
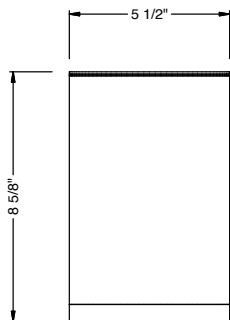

PROJECT INFORMATION		
JOB NAME		TYPE
ORDERING CODE		

BEAM ORDERING CODE											
<b>SERIES</b>	<b>EXT</b>	exterior									
<b>TYPE</b>	<b>6CS</b>	6" cylinder surface, 27W									
<b>LED</b>	<b>SW</b>	standard white									
<b>DELIVERED LUMENS</b>	<b>30LM</b>	2700 lm									
		Standard Configuration: 3000K Calculated Delivered Lumens = [Delivered Lumen Value] x [CCT Multiplier] x [Optic Multiplier]									
<b>CCT</b>	<b>30K</b>	3000K									
	<b>40K</b>	4000K									
		<table border="1"> <thead> <tr> <th>CCT</th> <th>3000K</th> <th>4000K</th> </tr> </thead> <tbody> <tr> <td>CRI</td> <td>90</td> <td>90</td> </tr> <tr> <td>CCT MULTIPLIER FOR LUMEN OUTPUT</td> <td>1</td> <td>1.1</td> </tr> </tbody> </table>	CCT	3000K	4000K	CRI	90	90	CCT MULTIPLIER FOR LUMEN OUTPUT	1	1.1
CCT	3000K	4000K									
CRI	90	90									
CCT MULTIPLIER FOR LUMEN OUTPUT	1	1.1									
<b>CRI</b>	<b>90</b>	90 CRI									
<b>OPTIC &amp; LM MULTIPLIER</b> SEE PAGE 3	<b>25D</b>	25° reflector (1.00)									
	<b>35D</b>	35° reflector (0.94)									
	<b>55D</b>	55° reflector (0.98)									
	<b>SLT<sup>1</sup></b>	70° X 10° louver (0.05)									
<b>FINISH</b>	<b>BK</b>	anthracite									
	<b>SV<sup>2</sup></b>	silver									

BEAM ORDERING CODE		
<b>MOUNTING OPTIONS</b>	<b>S</b>	surface mount
<b>VOLTAGE</b>	<b>UNV-10V</b>	120V-277V integrated driver, flicker free 0-10V dimming to 10%

YOUR COMPLETED ORDERING CODE	
Follow the steps to specify your fixture, example:	
<b>EXT - 6CS - SW - 30LM - 30K - 90 - 35D - BK - S - UNV - 10V</b>	

**NOTES**

1. Slit louver for light affect, not available with 25D/35D/55D.
2. Silver only offered in 3000K and non-dimmable.

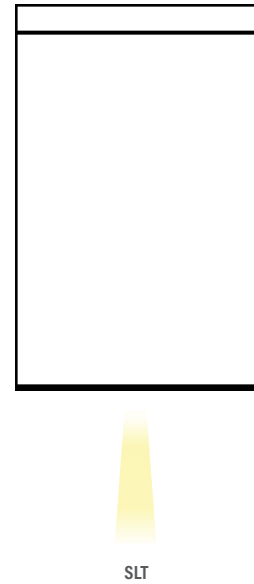
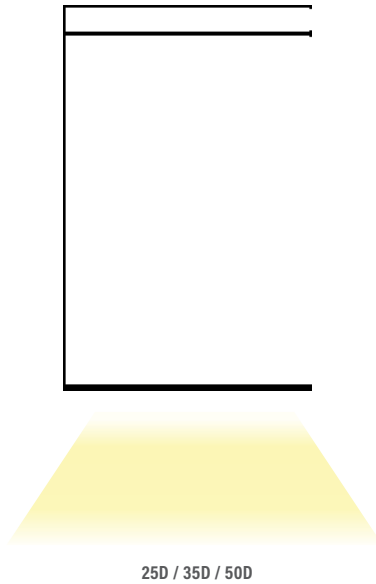

**PROJECT INFORMATION**

JOB NAME		TYPE	
ORDERING CODE			

**PHOTOMETRIC DATA**

**14LM CCT MULTIPLIERS**

	90CRI
3000K	1
4000K	1.1
FC Formula = CBCP / Distance <sup>2</sup>	

**25D  
25°**

WATTS: 26.7	LPW: 102.4
LUMENS: 2734	CCT: 3000K
INTENSITY	
DEGREE	CANDELA
0	8747
5	7537
15	3598
25	1392
35	702
45	28

**35D  
37°**

WATTS: 26.7	LPW: 96.5
LUMENS: 2577	CCT: 3000K
INTENSITY	
DEGREE	CANDELA
0	5339
5	5214
15	3588
25	1383
35	712
45	32

**55D  
57°**

WATTS: 26.7	LPW: 100.3
LUMENS: 2677	CCT: 3000K
INTENSITY	
DEGREE	CANDELA
0	3328
5	3284
15	2914
25	1939
35	1003
45	55